

SPARTAN WALL MOUNT SOAP - MAINS

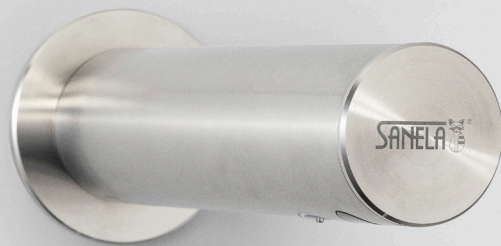

Installation
& maintenance
instructions.

General Information

- Designed for indoor use only. Do not expose to elements of nature.
- All plumbing and electrical connection must be made in accordance with AUS / NZ standards.
- Designed for the use of liquid type soap, refillable tank (1 litre).

Warnings

- Read all instructions before attempting to install this system. It is recommended a qualified & registered plumber completes the install.

Operating Instructions and Parts Manual

Please read carefully before attempting to assemble, install, operate or maintain the product described. Protect yourself and others by observing all safety information. Failure to comply with instructions could result in personal injury and/or property damage. Retain instructions for future reference.

Sanela Spartan Wall Mount Sensor Soap

Sensor activated soap tap with refillable 1litre tank, intended for liquid soap. Stainless steel construction. Complete the look with matching tapware.

Specifications

Finish	Stainless steel construction
Power Supply	Mains - 230V AC, 50 Hz (input) - 24V (output)
Control	Infrared sensing
Operating Voltage	24V DC
Active Range	0.11 – 0.15m START/STOP program 1.3 – 13secs
Dispense Type	Refillable liquid soap (1 litre)
Recommended Soap Viscosity	10 mPa*s – 5000 mPa*s (don't use chemical solvents and disinfectant)
Dimensions	Tap Ø 50mm, Nosing 164mm, Discharge height 300mm min from bottom of sink, Discharge depth 123mm
Warranty	24 Months

Planning

- Piping and electronics need to be installed prior to wall linings
- Internal piping from soap tap to peristaltic pump to be installed at a maximum vertical distance of 600mm
- Soap canister and peristaltic pump to be installed at a maximum distance apart of 150mm
- Soap tap to be a minimum distance 300mm from sensor to bottom of sink
- Ensure the sensor is not directly above the waste (reflective surface)
- Peristaltic pump can be located above or beneath soap tap
- Ensure soap canister is accessible for ease of refilling

Components

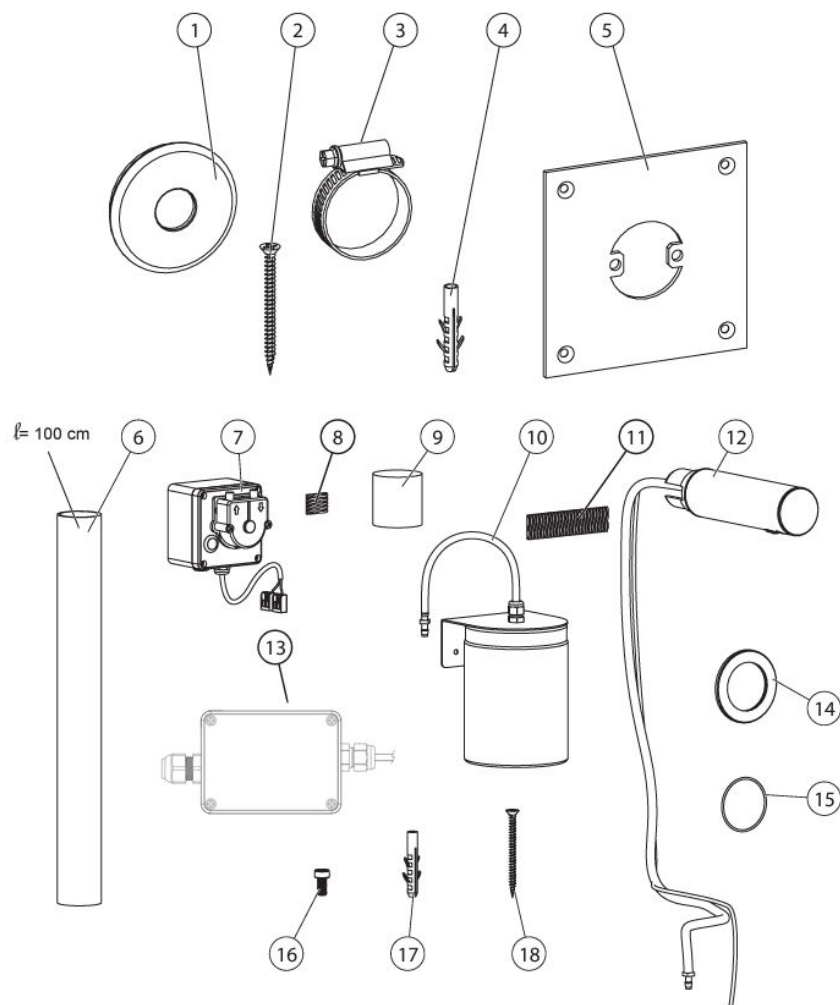

1	Mounting plate (bottom)
2	Screw x4
3	Hose clamp
4	Dry wall anchor x2
5	In-wall back plate (stainless steel)
6	Flex hose
7	Peristaltic pump
8	Velcro tape (small)
9	Temporary cap
10	Soap canister
11	Velcro tape (large)
12	Soap tap
13	Power transformer
14	Mounting plate (top)
15	Seal / O-ring x2
16	Bolt x2
17	Dry wall anchor x2
18	Screws

Standard Functions

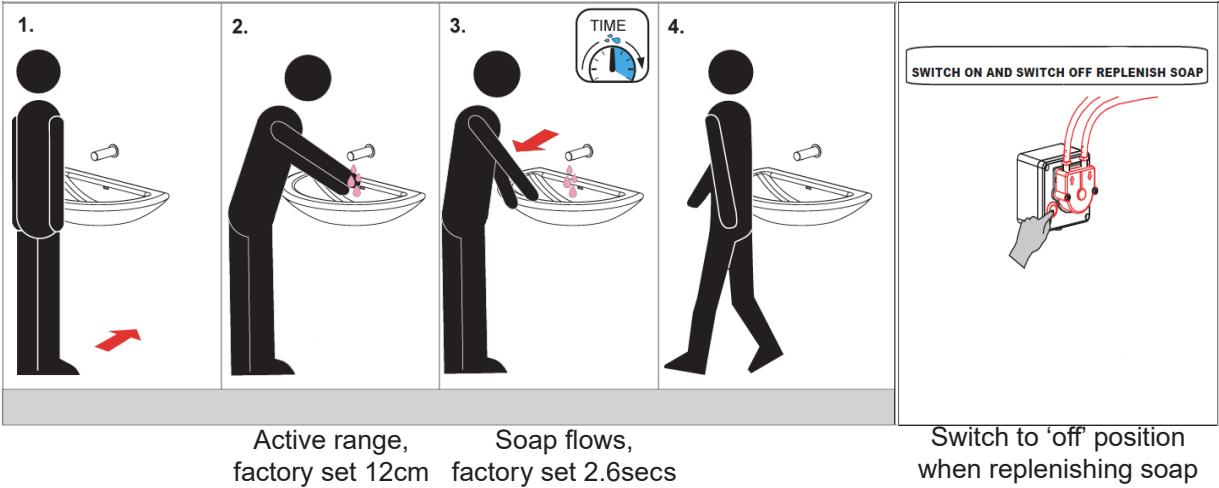

Typical Set Up

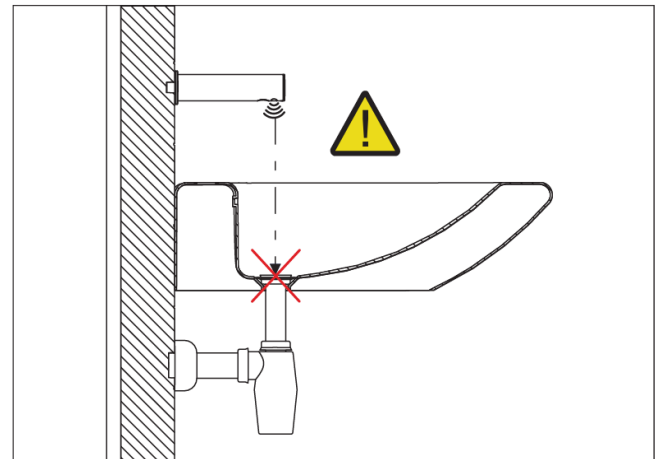
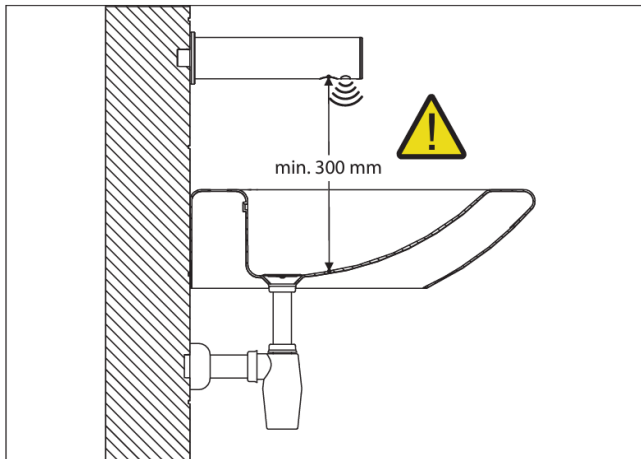
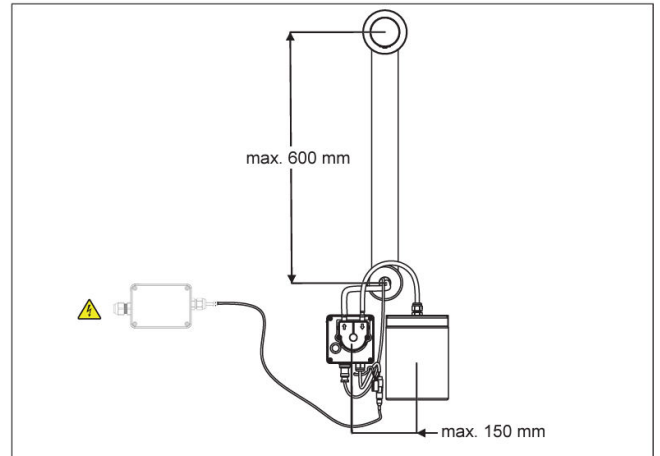
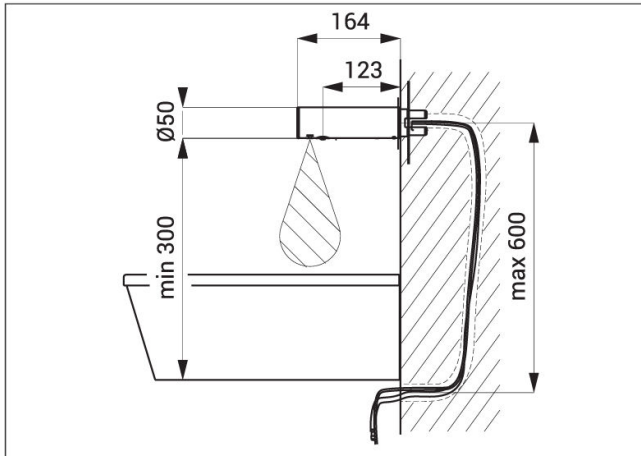

- Internal piping from soap tap to peristaltic pump to be installed at a maximum vertical distance of 600mm
- Soap canister and peristaltic pump to be installed at a maximum distance apart of 150mm
- Soap tap to be a minimum distance 300mm from sensor to bottom of sink
- Ensure the sensor is not directly above the waste (reflective surface)
- Peristaltic pump can be located above or beneath soap tap
- Ensure soap canister is accessible for ease of refilling

External Power Supply Installation

Input	230V / 50 Hz
Output	24 V DC
IP rating	IP 55
Operating temperature	5°C - 40°C
Rated power	10W

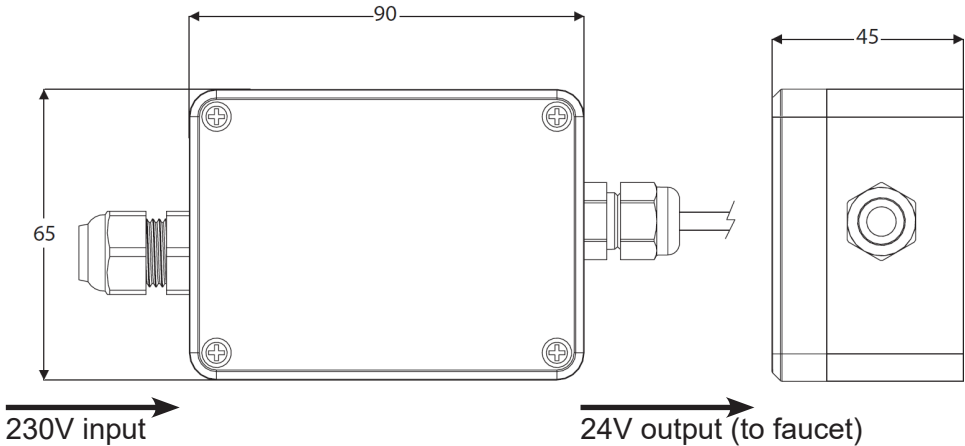

Important

To be installed in accordance with all NZ electrical regulations. It must be carried out by a qualified professional.

Positioning of the mounting box should be 500mm from the floor and consider:

- 1. Moisture ingress due to plumbing fault
- 2. Ongoing maintenance and accessibility

The mounting box can be surface mounted or within the service or ceiling cavity. (ie. wall mounted, refer to page 12)

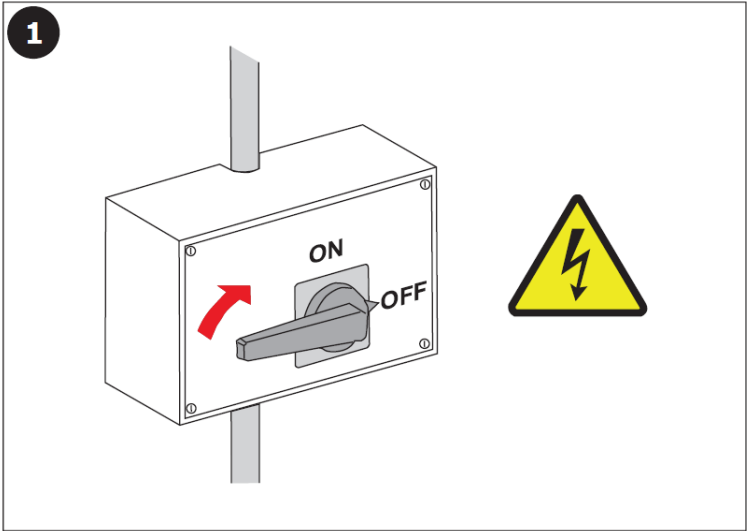

Ensure mains power supply is off

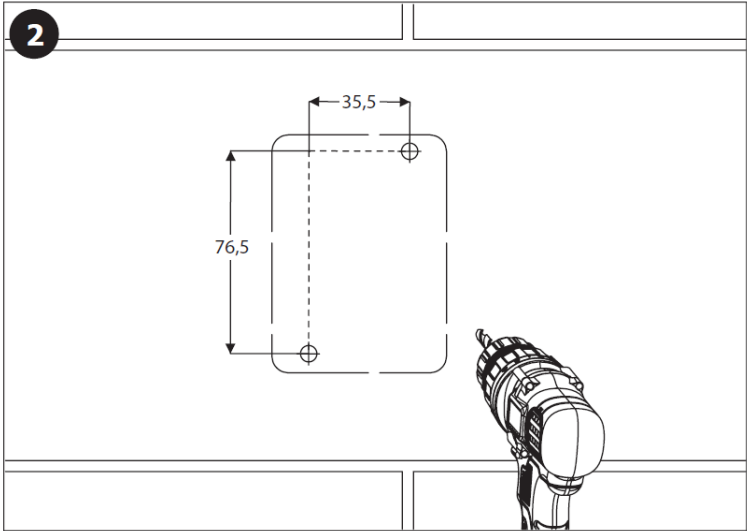

Mark mounting point(s) on surface

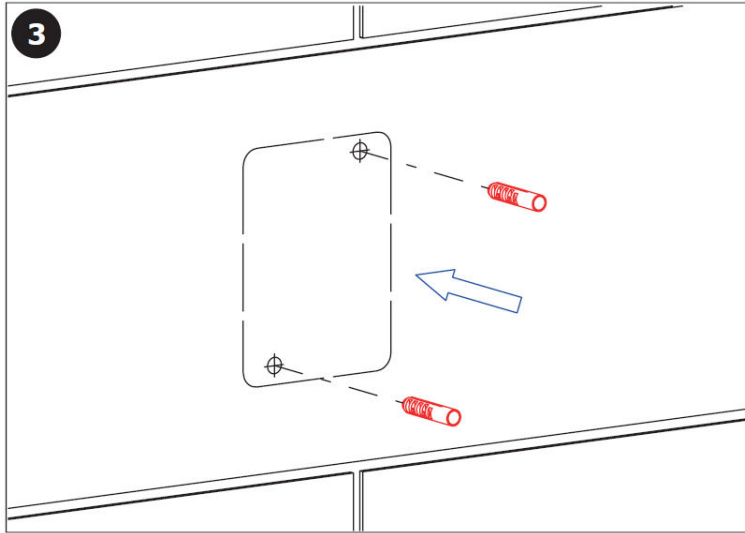

Drill and insert appropriate wall anchors if required

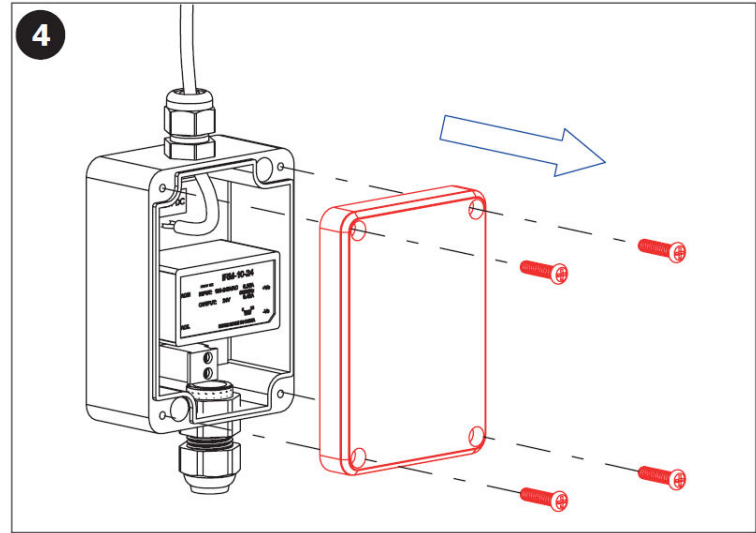

Remove cover from mounting box

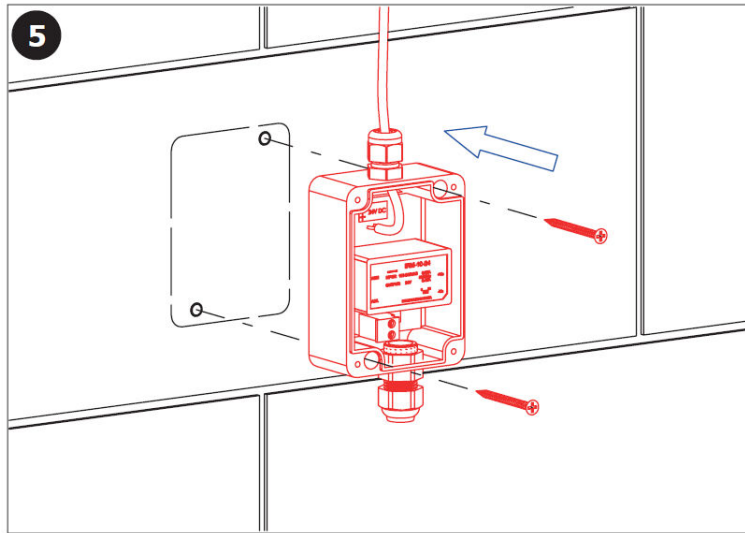

Fix mounting box to wall

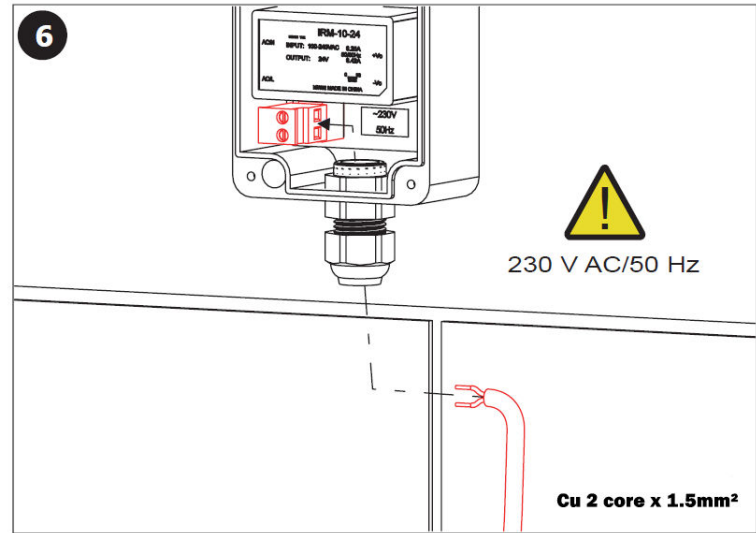

Pass mains (230V) power supply into mounting box via grommet and terminate accordingly

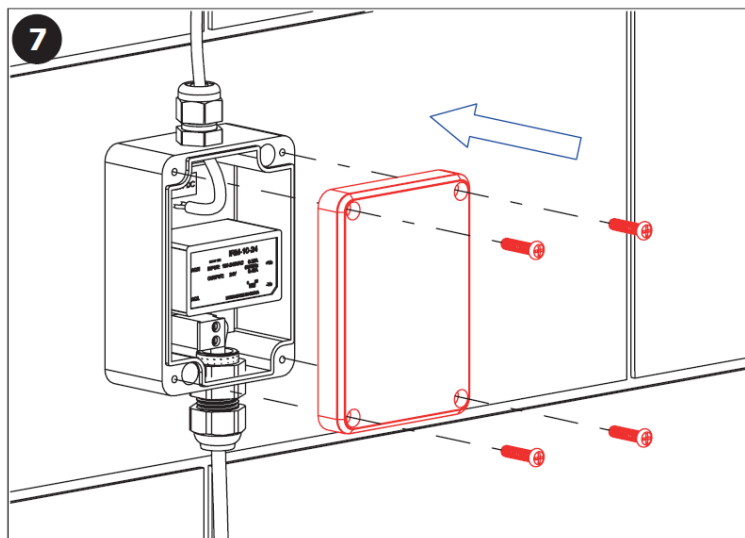

Reinstall cover of mounting box and ensure sealed. Tighten grommet to ensure snug around cables

Note: Power supply should be secured via current breaker before the external supply (not included)

Faucet Installation

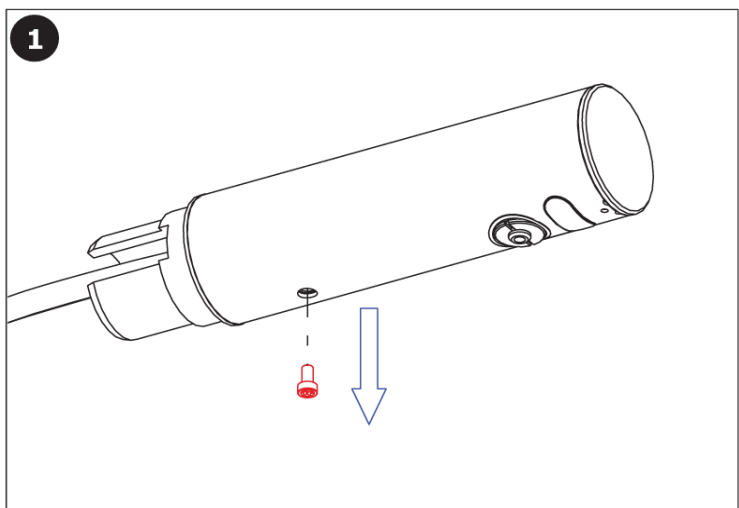

Remove torx screw from underside of soap faucet

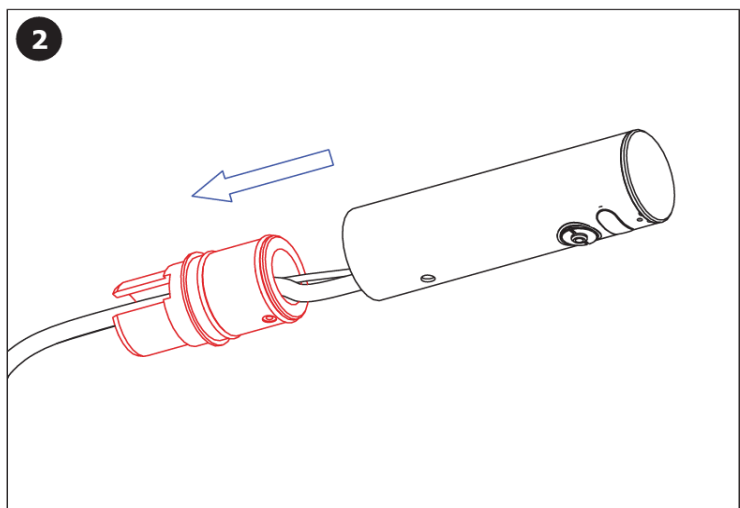

Remove inner tap end fitting from within soap faucet

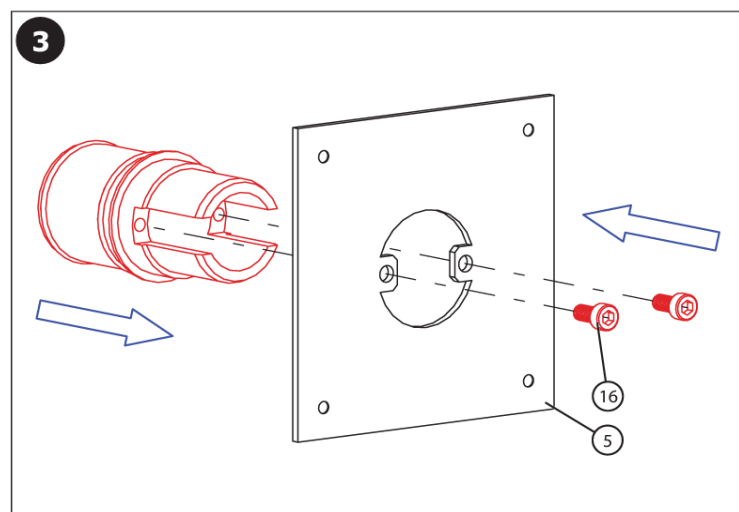

Note: Steps 3-10 should be completed prior to wall linings.
Slide back plate (5) over inner tap end fitting and fix with hex screws provided (16)

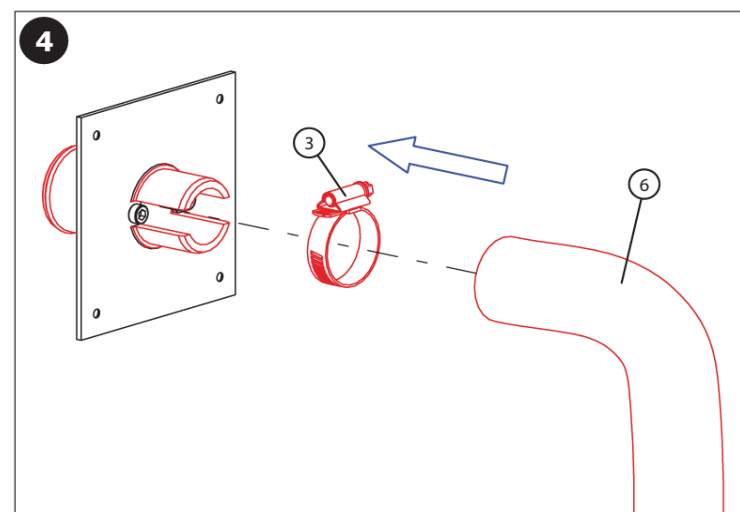

Attach flex hose (6) and tighten with hose clamp (3)

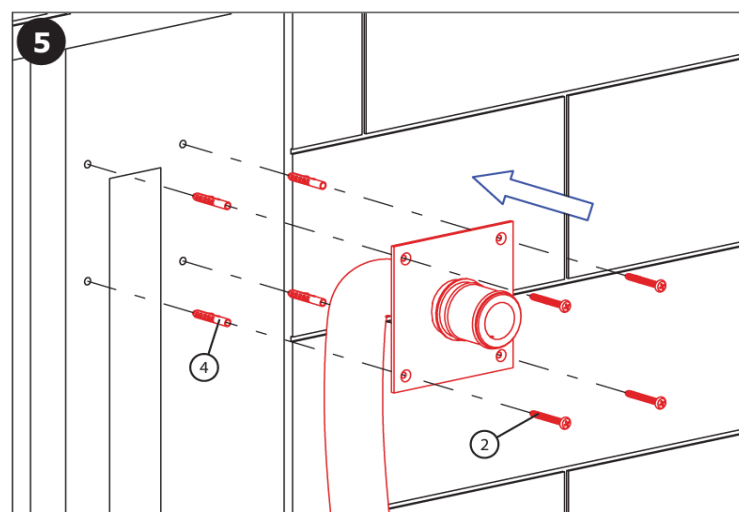

Place flex hose within wall cavity and fix back plate (2) securely to stud or sturdy surface using 4 x screws (2) and dry wall anchors (4) (if required)

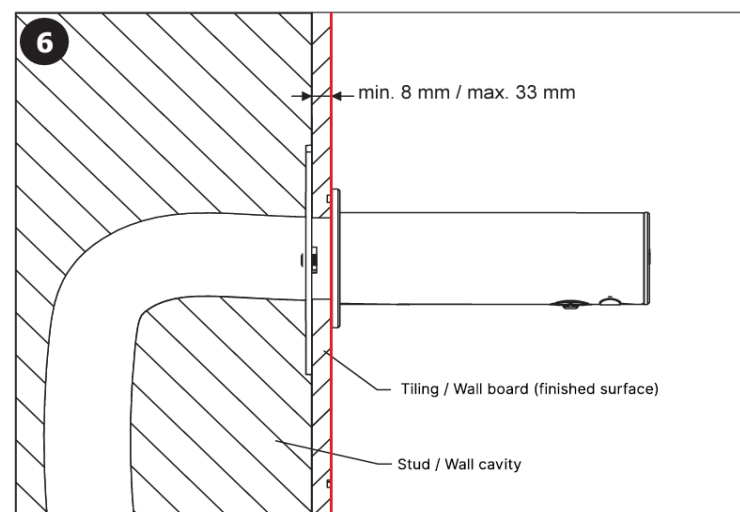

Note: Distance between back plate and faucet should be a minimum 8mm and maximum 33mm. Ensure back plate is level, secure and ideally flush with pre-tiled surface (if applicable)

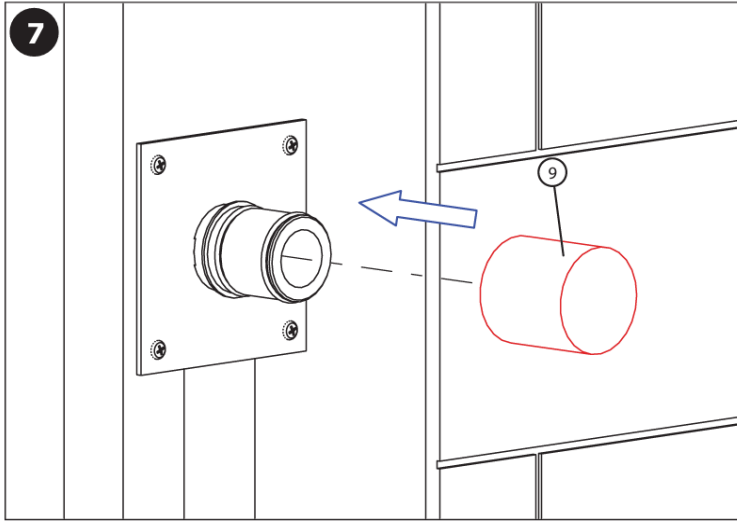

Place temporary cap over top opening of flex hose to avoid contamination while lining

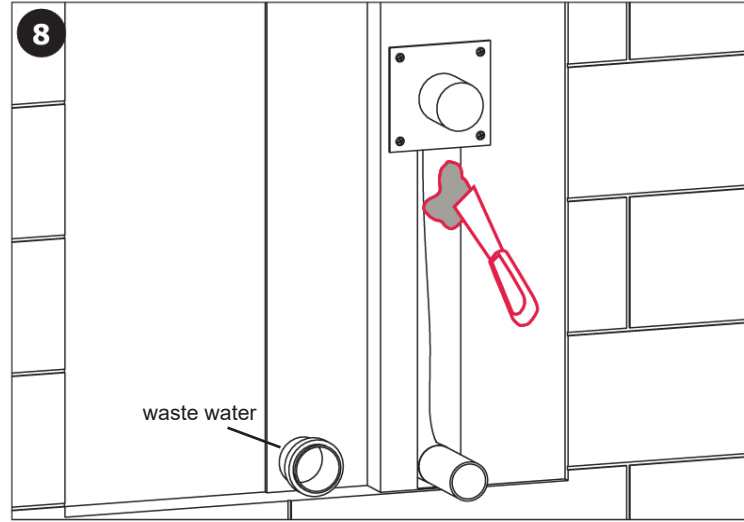

Line wall cavity and prepare the desired finish. Remember to consider finished surfaces distance from back plate

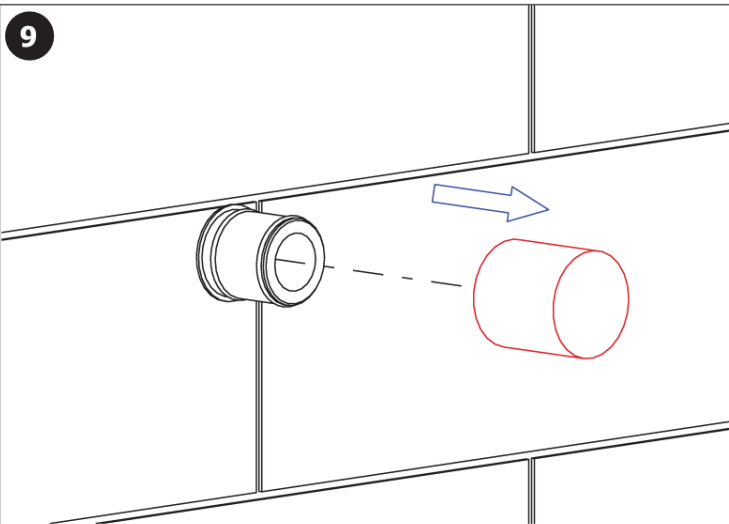

Once finished wall surface is complete, remove temporary cap from flex hose (top)

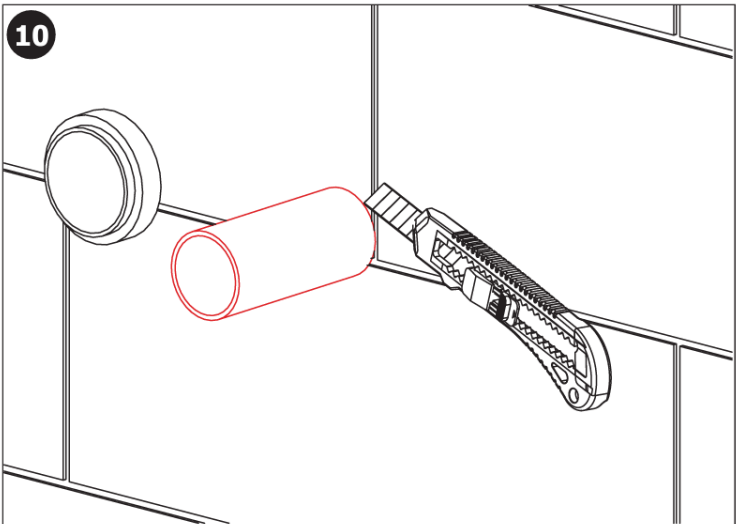

Using a craft knife, cut excess flex hose (bottom) flush with the wall (ensure to leave some purchase)

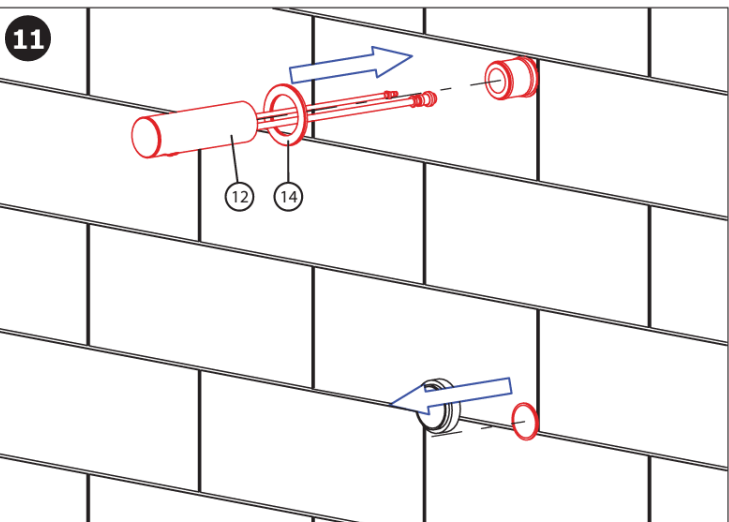

Pass faucet hosing and power cable through mounting plate (top) (14), then push through flex hose until it comes through the bottom end

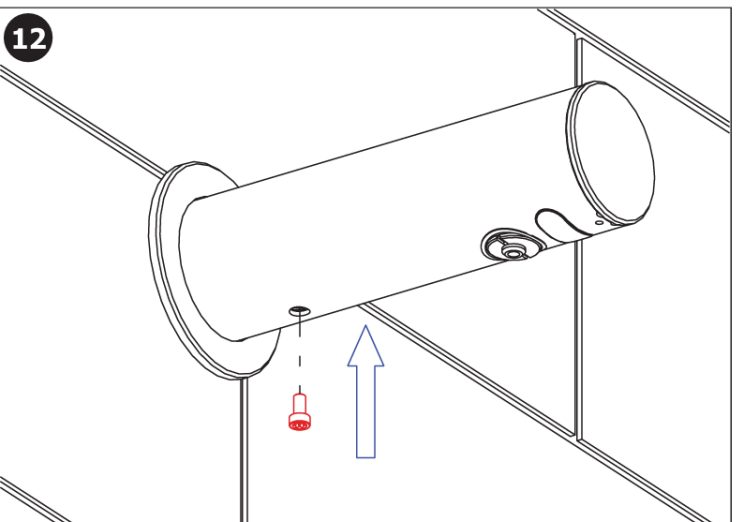

Fix faucet securely in place by tightening torx screw underside. Check level. Seal mounting plate.

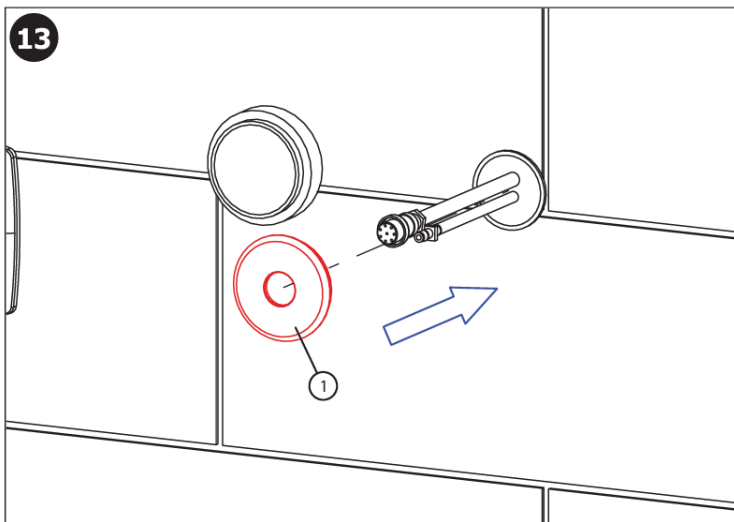

Pass soap and power cable through mounting plate (bottom) (1) and connect to flex hose. Gently fit into finished wall surface

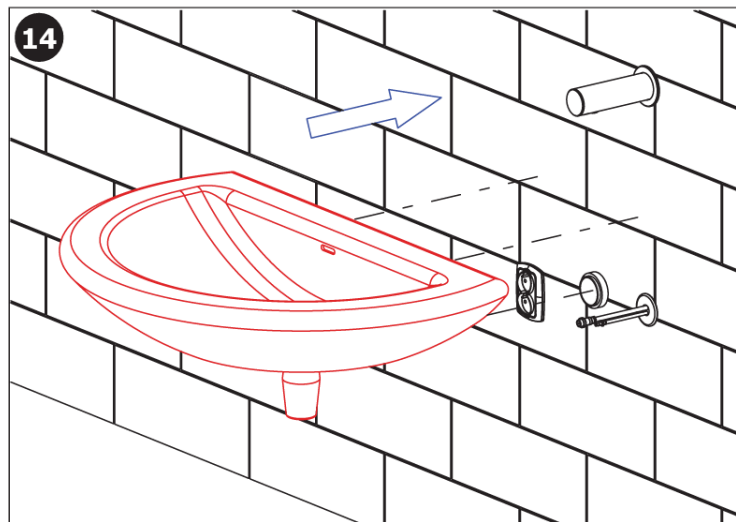

Install wash basin (if applicable)

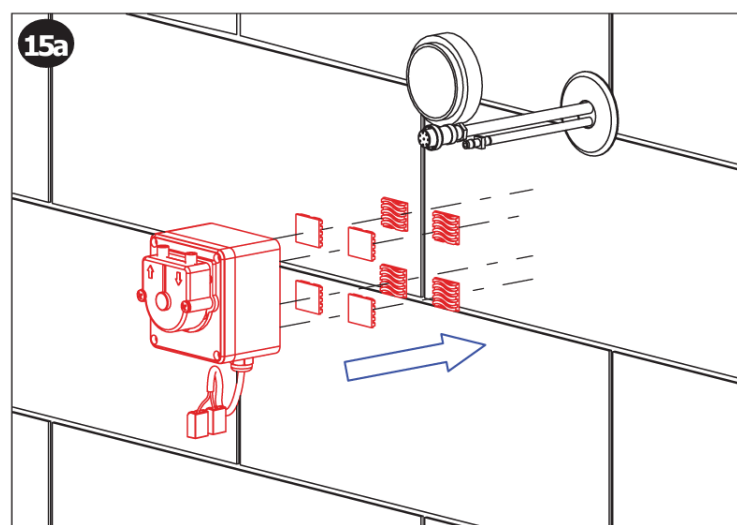

Option A: Clean wall with alcohol, then apply velcro tape (small) adhesive to wall first, then velcro to pump. Lastly, expose opposite adhesive side and press pump firmly to achieve a strong hold

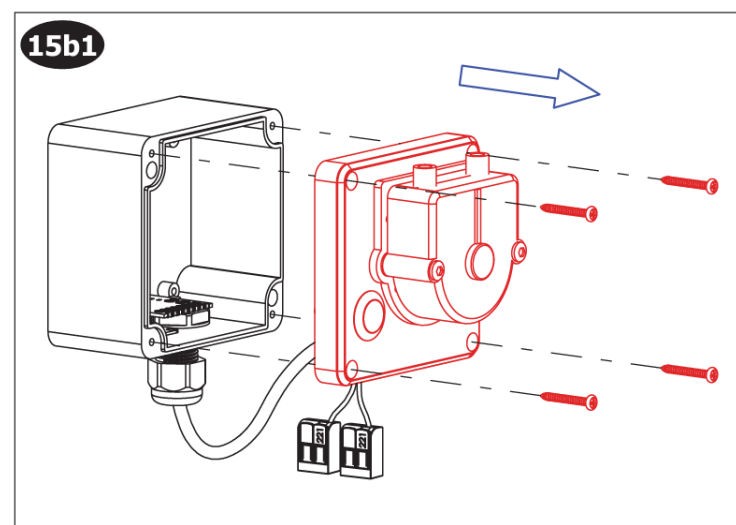

Option B: Remove cover from pump

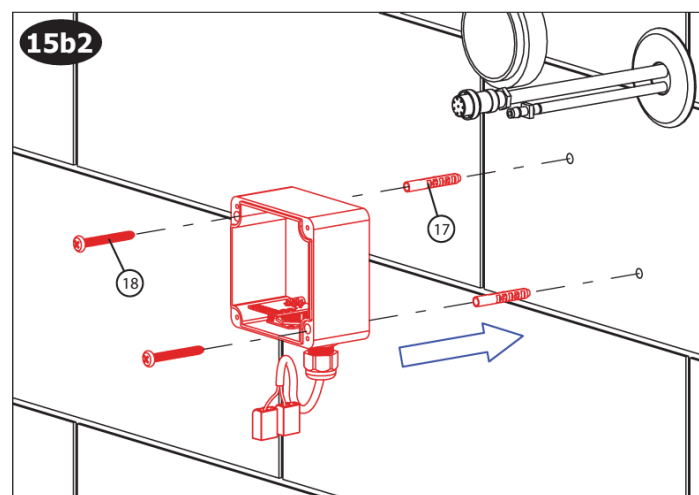

Mark mounting points on surface, drill and insert appropriate wall anchors if required, fix mounting box to wall

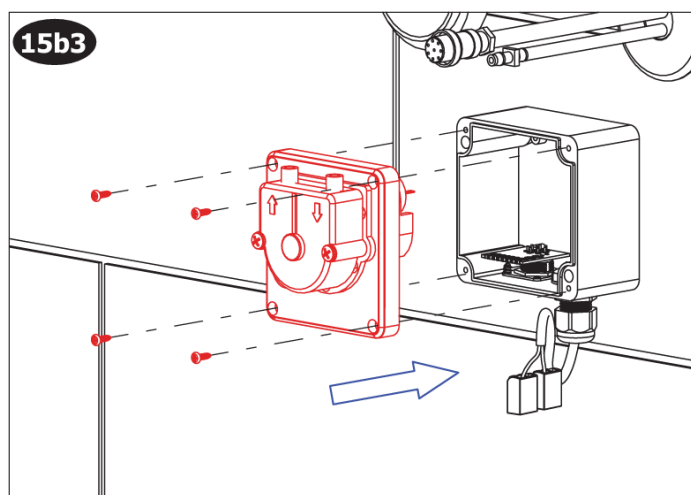

Reinstall cover of pump and ensure sealed

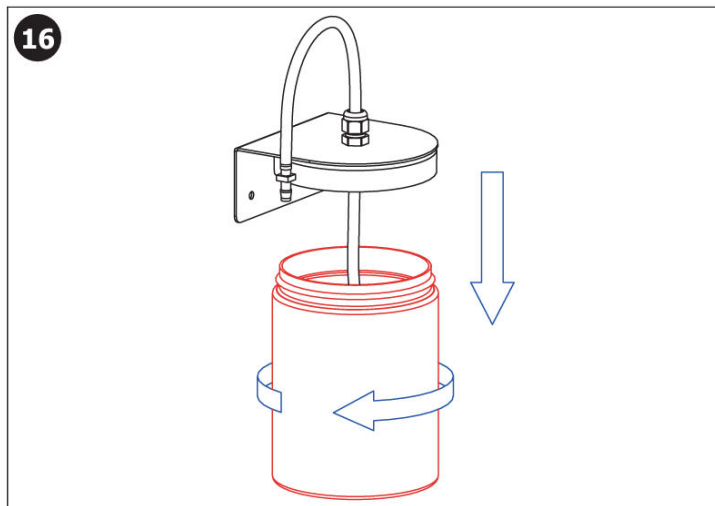

Unscrew soap canister from top plate

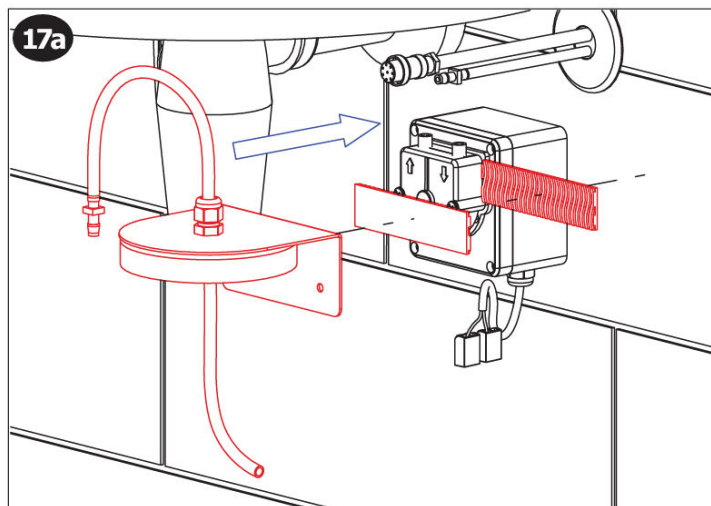

Option A: Fix soap canister top plate via adhesive velcro (large)

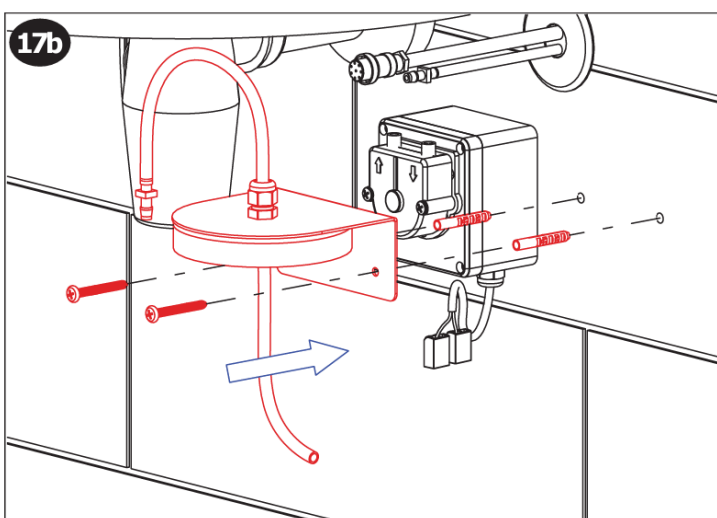

Option B: Fix soap canister top plate via screwing into the wall, using wall anchors if required

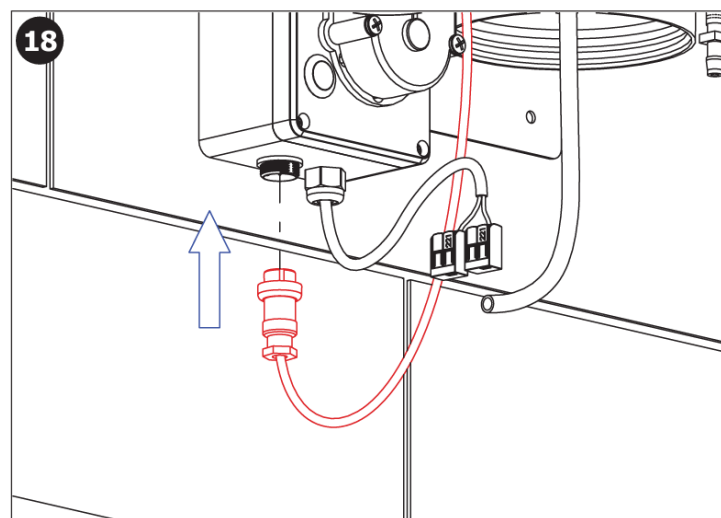

Connect electronics from soap tap into bottom socket of pump. Carefully align pins and tighten safety nut.

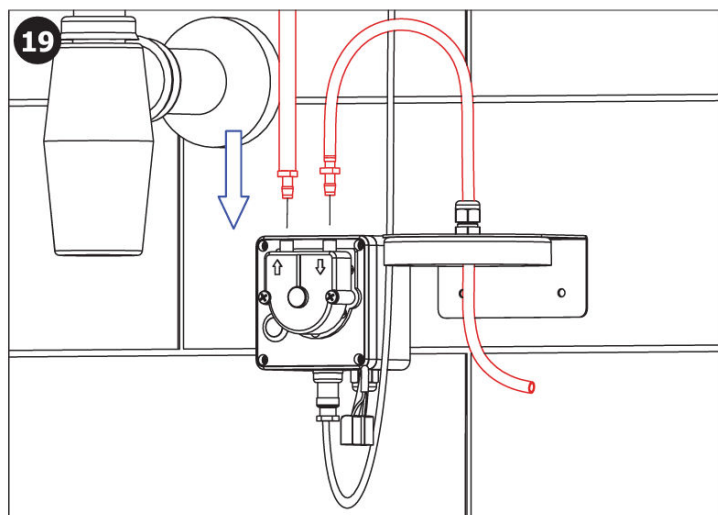

Connect soap canister and faucet to pump. Ensure to follow diagram regarding inward and outward direction

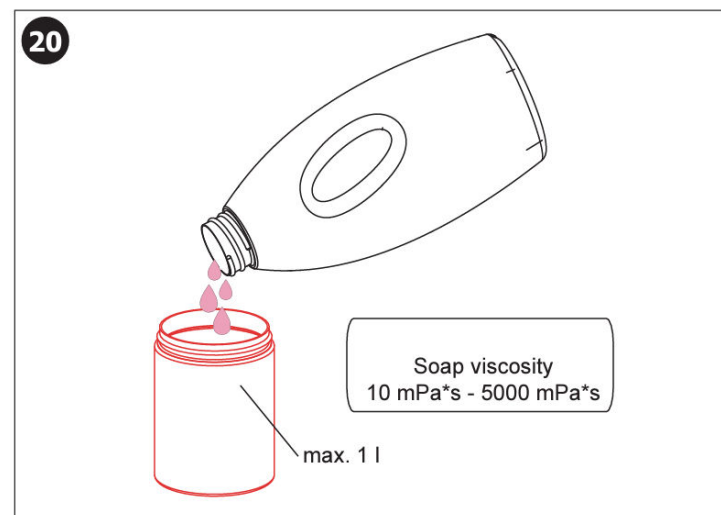

Fill soap canister with liquid soap (only)

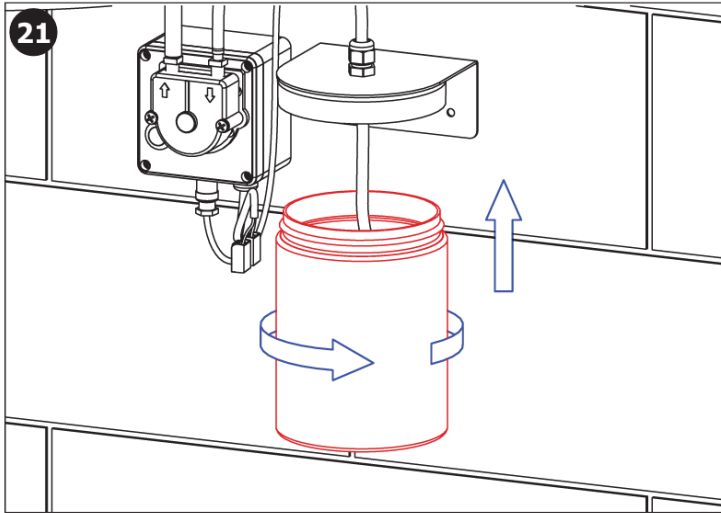

Screw soap canister into top plate

Connecting to Mains Power

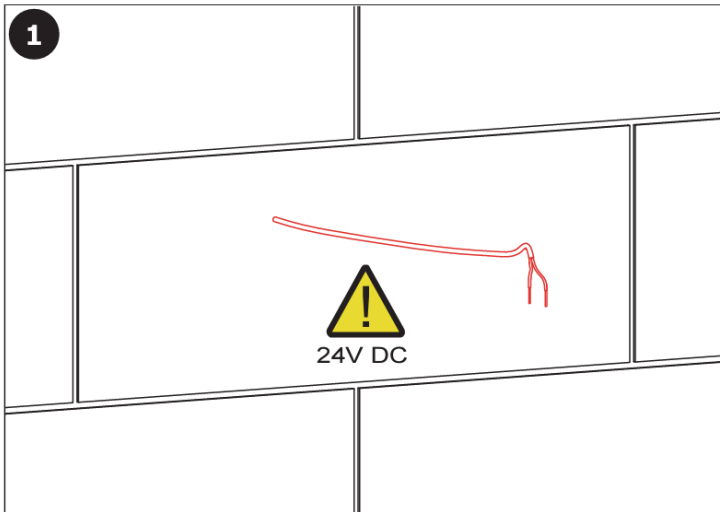

Pass power connection through wall

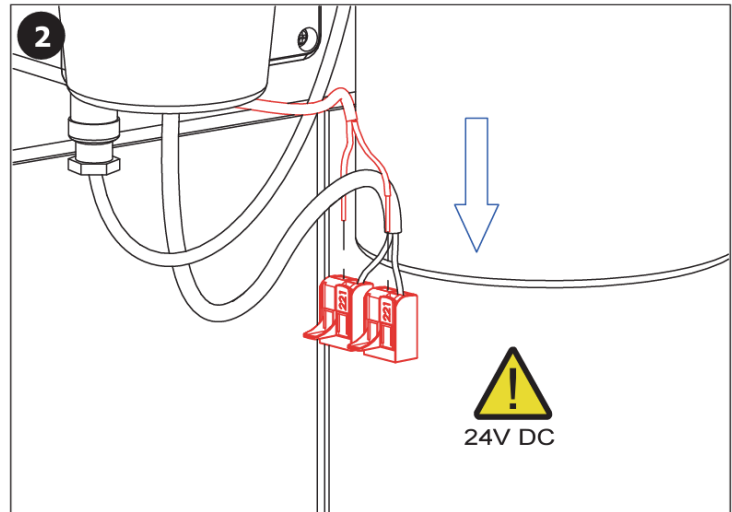

Connect external power (24V outlet) supply to wago connectors on faucet (Note polarity: brown to brown, white to white)

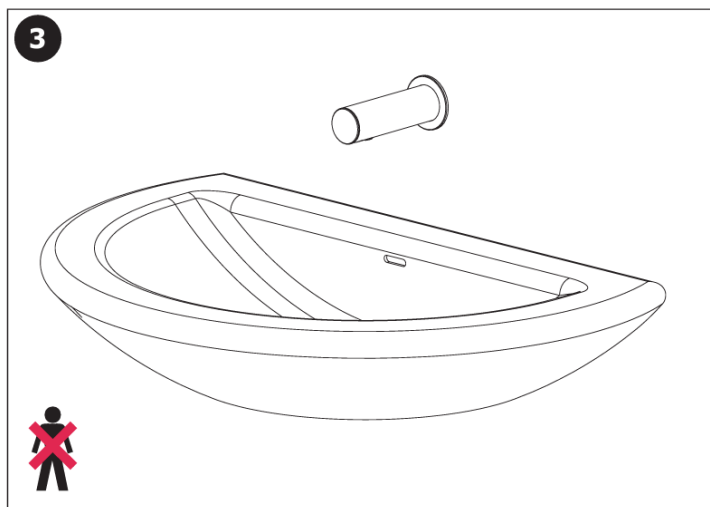

Do not come within active range

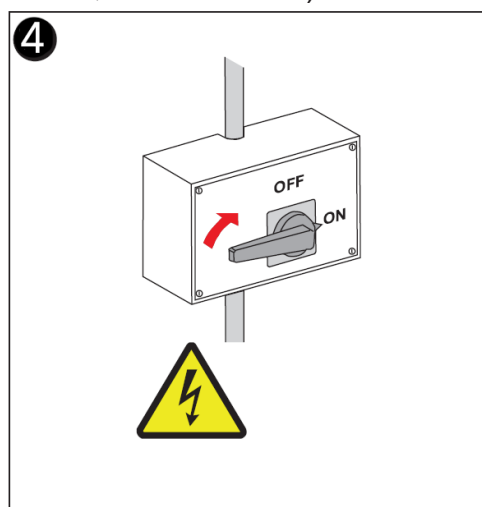

Turn power supply on. It is necessary, for the proper function, to keep the unit under constant voltage (don't connect the power supply unit behind the switch into the light circuit)

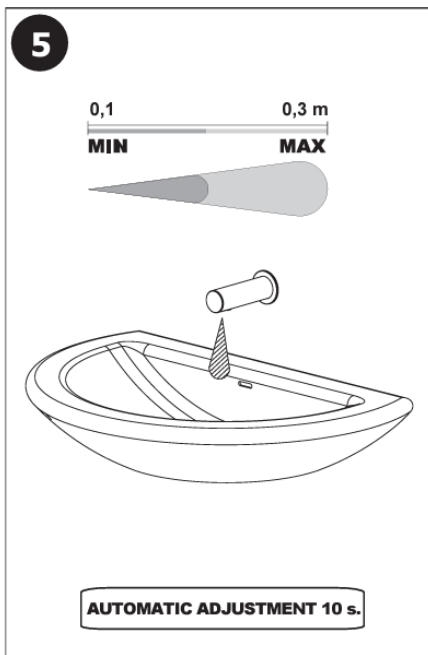

Once power turned on, faucet will automatically adjust sensing range during first 10 seconds. The LED on sensor will continually flash, do not come in active range during this time

Important

- Intended for liquid soap only. No particles or granules are permitted within soap, this may cause damage to the pump and/or possible blockages.
- The sensor of the faucet must not be obstructed.
- Avoid positioning reflective objects or surfaces in front of the faucet sensor. This can cause false activation i.e. mirrors opposite faucet.
- All plumbing and electrical installation must be carried out by a qualified person and in accordance with applicable codes and regulations.

Maintenance

- It is recommended that the pump and all filters be inspected for foreign debris and cleaned annually (more frequently if necessary)
- Clean faucet regularly using soapy water and a soft cloth or wet sponge
- DO NOT clean faucet with any abrasive material or chlorine/acid based cleaning product. This may damage the filter of the infrared sensor and/or the finishing of the faucet.

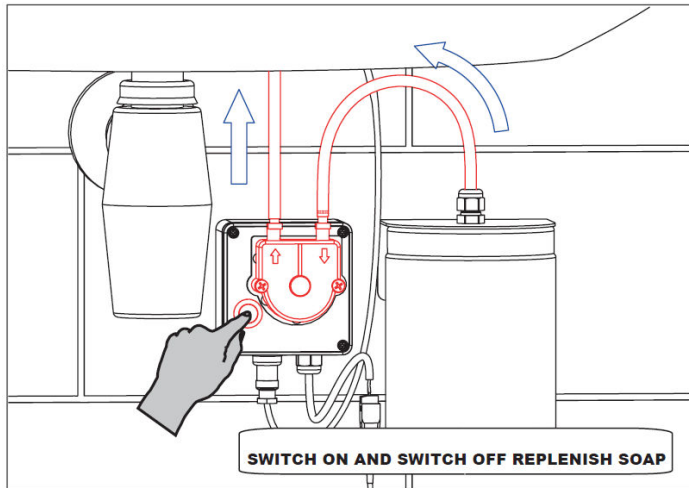

On/off switch located at the pump for replenishing soap tank

Note:

If you require to modify any of the factory settings please request the Sanela remote SLD03.

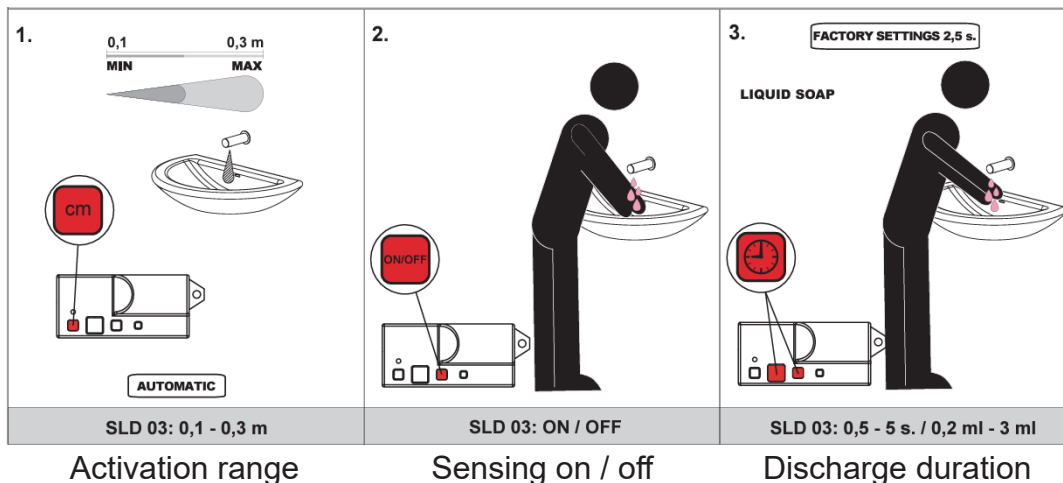

Troubleshooting

Symptom	Possible Cause	Corrective Action
No soap flow - is LED on sensor flashing red when hands are within active range?	<ul style="list-style-type: none"> a. Soap supply low b. Blocked soap pipes c. Is pump activating? d. Faulty pump 	<ul style="list-style-type: none"> a. Replenish soap b. Flush soap pipes c. Check all hose connections, re-prime using switch on pump d. Replace pump
No soap flow - LED on sensor NOT flashing when hands are within active range.	<ul style="list-style-type: none"> a. Power supply b. Power connections to faucet (wago connectors) c. IR sensor damaged d. Faulty IR sensor 	<ul style="list-style-type: none"> a. Ensure power at source b. Check all connections and polarity c. Replace IR sensor filter d. Replace IR sensor
Soap doesn't stop flowing	<ul style="list-style-type: none"> a. Dirty IR sensor b. Obstruction in detection zone c. Water drop on sensor eye d. Ghost sensing due to reflection 	<ul style="list-style-type: none"> a. Clean IR sensor b. Remove obstruction c. Wipe sensor d. Remove reflective surface or reposition

Supreme Comprehensive Warranty

Your Sanela Sensor Tap is fully guaranteed against defective materials and faulty workmanship commencing from the date of sale (according to SPL's records), subject to it being installed and maintained in accordance with the manufacturer's instructions.

SPL (2021) Limited warrants that should any part of the sensor tap fail within the given warranty period (24 months), it will be remedied by SPL. The tap should be returned to SPL (2021) Limited for all warranty claims. The cost of cartage will be payable by the customer.

Due to the significant variation in tradesmen's knowledge, experience, and productivity, labour charges will NOT be accepted unconditionally. We strongly recommend contacting our office for advice before proceeding with any warranty repairs.

This warranty excludes:

- Incorrect installation, or installation that does not specifically follow the installation guidelines supplied
- Defects arising from improper installation, or incorrect electrical supply where applicable
- Failure to follow manufacturer's maintenance instructions
- Damage/Failure resulting from:
 - the use of non-authorized parts
 - authorised parts not installed in accordance with the manufacturer's instructions
 - accidental damage, negligent use, misuse, vandalism, neglect
 - damage caused either directly or indirectly by external sources (incorrect power supply, natural disaster, or insect infestation)
- Water ingress caused by property maintenance or flooding
- Negligent cleaning practices (water ingress, harmful chemical etc)

The above includes consequential damage to any other goods, furnishings, or property.

- Normal wear and tear and consumable parts (batteries etc)
- This warranty does not displace any statutory warranty in relation to the dispenser but any liability of SPL (2021) Limited under any statutory warranty will be limited to a replacement or repair of the dispenser or payment of the cost of such replacement or repair at the sole discretion of SPL (2021) Limited

Note:

- Warranty only extends to products purchased and installed in New Zealand.
- Contamination or poor water quality is not covered by product warranty.
- Damage to solenoid caused by inadequate flushing or excess water pressure is not covered by the product warranty.

SPL Limited
Cambridge 3434
New Zealand

p. +64 7 823 5790
e. office@splwashrooms.co.nz